

YGI-0720

**YG** NanoCut

**Mini utensili in Metallo Duro  
per barenatura e  
profilatura**



## Chiavi di lettura - Porta utensili e utensili di barenatura

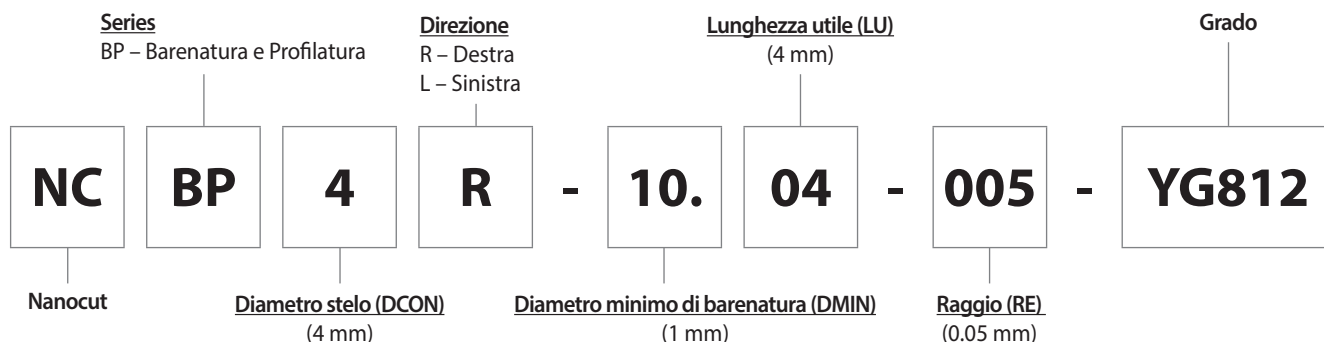

### Corpi

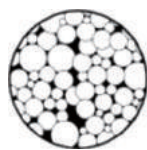
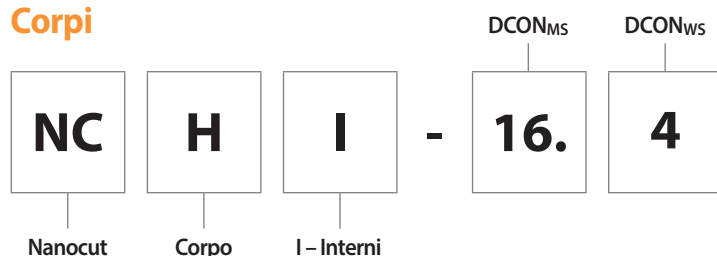

### YG812 - Metallo duro micrograna

P10 - P20

M20 - M30

Metallo duro con substrato ad elevata tenacità e resistenza all'usura

K20 - K30

S10 - S25

YG812			Velocità di taglio (m/min.)		Avanzamento a giro (mm/giro)	
ISO	VDI	Gruppo materiali	Vc (m/min.)		Fn (mm/rev.)	
			Min	Max	Min	Max
P	1~5	Acciai non legati	170	200	0.015	0.025
	6~9	Acciai basso legati	95	160	0.015	0.025
	10~11	Acciai alto legati	85	95	0.015	0.025
M	12~13	Inox ferritici e martensitici	105	140	0.015	0.025
	14	Inox Austenitici	95	130	0.015	0.025
K	15~16	Ghisa grigia	140	190	0.015	0.025
	17~18	Ghisa nodulare	140	190	0.015	0.025
N	21~30	Alluminio	-	-	-	-
S	31~37	Leghe resistenti al calore	10	75	0.015	0.025
H	38~41	Acciai temprati	-	-	-	-

# Bareni

## BP - Barenatura & Profilatura

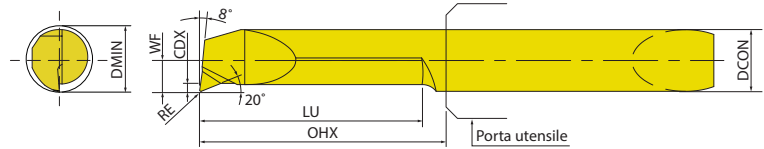

KAPR	DCON	Descrizione	CODICE NCBP..	Grado	DMIN	LU	RE	CDX	WF	OHX
98°	4 mm	NCBP4R-10.04-005-YG812	04R1004005T	YG812	1	4	0.05	0.1	0.45	13
		NCBP4R-10.04-010-YG812	04R1004010T		1	4	0.1	0.1	0.45	13
		NCBP4R-10.06-005-YG812	04R1006005T		1	6	0.05	0.1	0.45	13
		NCBP4R-10.06-010-YG812	04R1006010T		1	6	0.1	0.1	0.45	13
		NCBP4R-17.06-010-YG812	04R1706010T		1.7	6	0.1	0.2	0.7	13
		NCBP4R-17.09-010-YG812	04R1709010T		1.7	9	0.1	0.2	0.7	13
		NCBP4R-22.06-010-YG812	04R2206010T		2.2	6	0.1	0.2	0.95	13
		NCBP4R-22.09-010-YG812	04R2209010T		2.2	9	0.1	0.2	0.95	13
		NCBP4R-22.13-010-YG812	04R2213010T		2.2	13	0.1	0.2	0.95	18
		NCBP4R-27.10-015-YG812	04R2710015T		2.7	10	0.15	0.2	1.2	13
		NCBP4R-27.15-015-YG812	04R2715015T		2.7	15	0.15	0.2	1.2	18
		NCBP4R-32.10-015-YG812	04R3210015T		3.2	10	0.15	0.2	1.45	13
		NCBP4R-32.15-015-YG812	04R3215015T		3.2	15	0.15	0.2	1.45	18
		NCBP4R-32.20-015-YG812	04R3220015T		3.2	20	0.15	0.2	1.45	23
		NCBP4R-42.10-015-YG812	04R4210015T		4.2	10	0.15	0.3	1.95	13
		NCBP4R-42.15-015-YG812	04R4215015T		4.2	15	0.15	0.3	1.95	18
		NCBP4R-42.20-015-YG812	04R4220015T		4.2	20	0.15	0.3	1.95	23
		NCBP4R-42.25-015-YG812	04R4225015T		4.2	25	0.15	0.3	1.95	28
	6 mm	NCBP6R-62.15-020-YG812	06R6215020T		6.2	15	0.2	0.5	2.95	18
		NCBP6R-62.20-020-YG812	06R6220020T		6.2	20	0.2	0.5	2.95	23
		NCBP6R-62.25-020-YG812	06R6225020T		6.2	25	0.2	0.5	2.95	28
		NCBP6R-62.30-020-YG812	06R6230020T		6.2	30	0.2	0.5	2.95	33
		NCBP6R-62.35-020-YG812	06R6235020T		6.2	35	0.2	0.5	2.95	38
		NCBP6R-62.40-020-YG812	06R6240020T		6.2	40	0.2	0.5	2.95	43

## Porta utensili

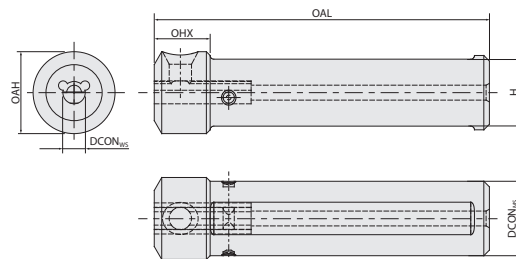

Scala	OHX	Diam. Inserto (DCON <sub>MS</sub> )	Descrizione	CODICE ZBR..	DCON <sub>MS</sub>	OAL	H	OAH
Metrico (mm)	14	4 mm	NCHI-12.4	0400012	12	70	10	15.5
			NCHI-16.4	0400016	16	75	14	17.5
			NCHI-20.4	0400020	20	90	18	20
		6 mm	NCHI-12.6	0600012	12	70	10	16.5
			NCHI-16.6	0600016	16	75	14	18.5
			NCHI-20.6	0600020	20	90	18	22

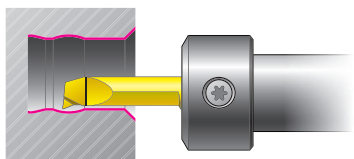

### Applicazioni

- Tornitura interna di piccoli componenti
- Barenatura / Profilatura - Gole radiali - Filettatura - Smussatura

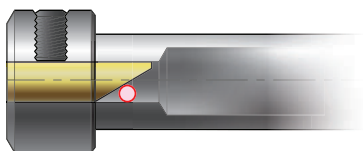

### Specifiche

- Minimo diametro di lavorazione 1,00 mm
- Canalini di refrigerazione per incrementare la vita utensile e evacuazione del truciolo
- Montaggio sicuro e stabile



### Vantaggi

- Elevata ripetibilità
- Prolungata vita utensile

### Benefici

- Ridotti tempi di fermo macchina
- Costi di lavorazione ridotti

**YG1 ITALY Srl**

Via di Valle Caia n° 109 - Roma - 00134( Rm )  
Telefono: 06.71300335, FAX: 06.71309635  
Web: <http://www.yg1.it> E-mail: [info@yg1.it](mailto:info@yg1.it)

